



MDR A2

FLXMOD

DC motor driver module

Description

FLXMOD™ system DC motors driver module. This unit, designed for mounting on a standard DIN rail and housed in a compact plastic case, is able to drive two DC-brush motors; speed and position control are possible whenever the motors are equipped with single or twin Hall sensors. Proprietary FLXIO™ bus ensure reliable real-time communication with the CPU.



Smitec S.p.A.

Via V. Veneto, 4 - 24016 San Pellegrino Terme (BG) ITALY
Tel. +39 0345 40.111 - Fax: +39 0345 40.809 - www.smitec.it

Head office:

Via C. Ceresa, 10 - 24015 San Giovanni Bianco (BG) ITALY
C.F. e P. IVA IT03790400166

| Technical data | |
|-------------------------------|--|
| Housing material | Polypropylene |
| Degree of protection | IP20 |
| Motor outputs | 2, for DC brush motors (24V _{DC}) |
| Outputs characteristics | MOSFET H-bridge, PWM controlled |
| Feedback inputs | For single or twin Hall sensor, open-collector type. The inputs are 24V tolerant |
| Feedback sensors power supply | 5V ± 10%, 100mA max. |
| Interface | Proprietary FLXIO™ |
| Bus address setting | By rotary switch |
| Electrical specifications | Power supplies: I/O supply: 24V _{DC} / 8A max. Logic supply: 24V _{DC} and 5V _{DC} from backplane |
| Environmental specifications | Operating temperature: from +5°C to +55°C Storage temperature: from -25°C to +85°C Relative humidity: from 10% to 95% (non-condensing) |

Dimensions

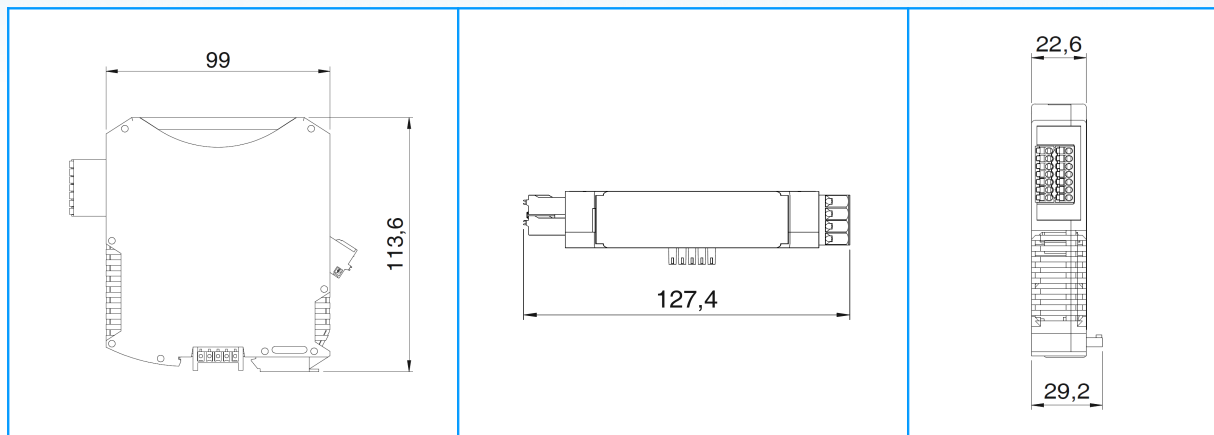

Data here mentioned are subject to changes without any notice.